

MODEL TCE15
ASSEMBLY INSTRUCTIONS

Important! Read all warnings before starting assembly.

READ THIS FIRST!

Read all of the warnings and cautions contained in this manual before assembly.

- Do not attempt to assemble this product if you do not understand the instructions.
- Contact a professional if you have any doubts about safe and secure TV furniture assembly.
- Check all the parts carefully to make sure there are no missing or damaged parts.
- Improper assembly may result in damage to your property and personal injury.
- Schoenfeld International Inc. and THUNDERDOG are not responsible for any personal injury or product damage due to mishandling, incorrect mounting, incorrect assembly or incorrect use of this product.

CHILD SAFETY WARNINGS

How and where you use this product is extremely important for Child Safety

As you set up and use your new product, keep all of these safety tips in mind

- ! Don't let children climb on or play with entertainment system furniture and TVs.
- ! Make sure to place or install the furniture where it cannot be pushed, pulled over, or knocked down.

WARNINGS

- This chair should be inspected regularly for loose or damaged parts, cracks, or general instability. Do not use this chair if there is damage of any kind as it may result in personal injury.
- Do not force the bolts into the hole or use an electric drill to fasten any bolts. This could damage the equipment or cause personal injury.

FOR YOUR SAFETY, PLEASE FOLLOW THESE PRECAUTIONS:

- ! Always remove all equipment from the furniture prior to moving the assembled unit.
- ! When in use, this furniture must be placed on a flat, level and solid surface.
- ! Do not rock back in the chair in a manner that any of the wheels come off the ground.
- ! Failure to keep all wheels of the chair on the ground can result in personal injury, and property damage.

- ! Do not climb or step on the unit.

Schoenfeld International Inc. and THUNDERDOG will not be responsible for failure to assemble as directed or for the improper assembly, use or handling of this product.

VEILLER Á RESPECTER CES MESURES DE PRECAUTION!

- ! TOUJOURS ENLEVER TOUT AUTRE ÉQUIPEMENT AVANT DE DÉPLACER LE MEUBLE ASSEMBLÉ.
- ! DURANT L'UTILISATION, LE MEUBLE DOIT ÊTRE POSÉ SUR UNE SURFACE PLATE, SOLIDE ET HORIZONTALE.
- ! NE VOUS PENCHEZ PAS EN ARRIÈRE DANS LA CHAISE EN QUELQUE SORTE QUE LES ROUES L'UNES DES SE DÉGAGENT LA TERRE.
- ! LE MANQUE DE GARDER TOUTES LES ROUES DU CHIAR AU SOL PEUT AVOIR COMME CONSÉQUENCE LE DOMMAGE CORPOREL, ET LES DÉGATS MATÉRIELS
- ! NE PAS GRIMPER NI MARCHER SUR LE MEUBLE.

POR SU SEGURIDAD TENGA LAS SIGUIENTES PRECAUCIONES:

- ! SIEMPRE QUITA TODO EL EQUIPO DE LOS MUEBLES ANTES DE MOVER LA UNIDAD.
- ! EL MUEBLE DEBE ESTAR UBICADO EN UNA SUPERFICIE PLANA, SÓLIDA Y NIVELADA CUANDO SE LO ESTE UTILIZANDO.
- ! NO SE INCLINE DETRÁS EN LA SILLA DE UNA FORMA QUE LAS RUEDAS UNAS DE LOS SALEN LA TIERRA.
- ! EL INCIDENTE DE GUARDAR TODAS LAS RUEDAS DEL CHIAR EN LA TIERRA PUEDE DAR LUGAR A DAÑOS CORPORALES, Y A DAÑOS MATERIALES
- ! NO SE SUBA NI SE PARE SOBRE EL SÓPORTE.

Schoenfeld International Inc. & THUNDERDOG decline toute responsabilité en cas d'assemblage non conforme aux instructions ou pour l'assemblage, l'utilisation ou la manutention incorrects de ce meuble.

Schoenfeld International Inc. & THUNDERDOG no se hara responsable en caso de que no se instale la base segun las instrucciones, ni de la instalación, uso o manejo incorrectos de esta base.



LIMITED ONE-YEAR FURNITURE WARRANTY

We warrant this product to you, the original purchaser at the time of purchase printed on a dated store receipt from an authorized THUNDERDOG retailer and for a period of one-year thereafter that our furniture product and all its parts and components are free of defects in material and workmanship under normal use. This warranty is subject to the provisions below. THUNDERDOG's sole obligation and the purchaser's exclusive remedy pursuant to these warranties are limited to replacement at THUNDERDOG's sole discretion. There are no other warranties except as expressly set forth below either expressed or implied, including any warranty of merchantability for any particular purpose.

Should you be missing any of the assembly parts or components (screws, pieces, etc.), please contact the Customer Support Center to secure a replacement. It is not necessary to bring the unit back to the store. When calling, please reference the parts list found in the Instruction Manual to help us accurately identify the missing parts and promptly provide replacements.

Our Customer Support Center is available Monday to Friday (9:00AM to 9:00PM EST) and Saturday (9:00AM to Noon) for technical assistance or troubleshooting. To contact us please call 1-800-936-1168.

This warranty is expressly limited to the replacement of furniture parts and components described in the parts list located in the Instruction Manual included with the product.

This warranty applies under conditions of normal use.

This warranty does not cover: any product, which has been subject to damage due to improper assembly or disassembly, products which were not assembled, installed, used, or maintained in accordance with the product assembly instructions & warnings, acts of nature, misuse, neglect, accidents, abuse, exposure to elements, outdoor use, extreme temperature ranges, damage during transit, commercial use, modification of, or to any part of the product or attachments to the product not approved by THUNDERDOG. Also not covered are costs for assembly/dis-assembly labor, costs incurred in shipping the unit or parts for warranty repair/exchange or any products purchased from unauthorized THUNDERDOG sellers. Under no circumstances shall THUNDERDOG, be liable for any loss (direct, indirect, incidental, foreseen, unforeseen, special or consequential) or for any damage arising out of, or in connection with, the use of this product. Nor shall THUNDERDOG have any responsibility for incidental or consequential damages resulting from the breach of this warranty including but not limited to inconvenience, purchase or rental of replacement products, loss of profits or commercial loss.

We reserve the right to request damaged parts or units be shipped to our offices for inspection or confirmation of any warranty claims.

This warranty does not cover product sold 'As Is'.

This warranty is valid only to the original purchaser of the Product in the United States and Canada and grants specific legal rights.

PARTS

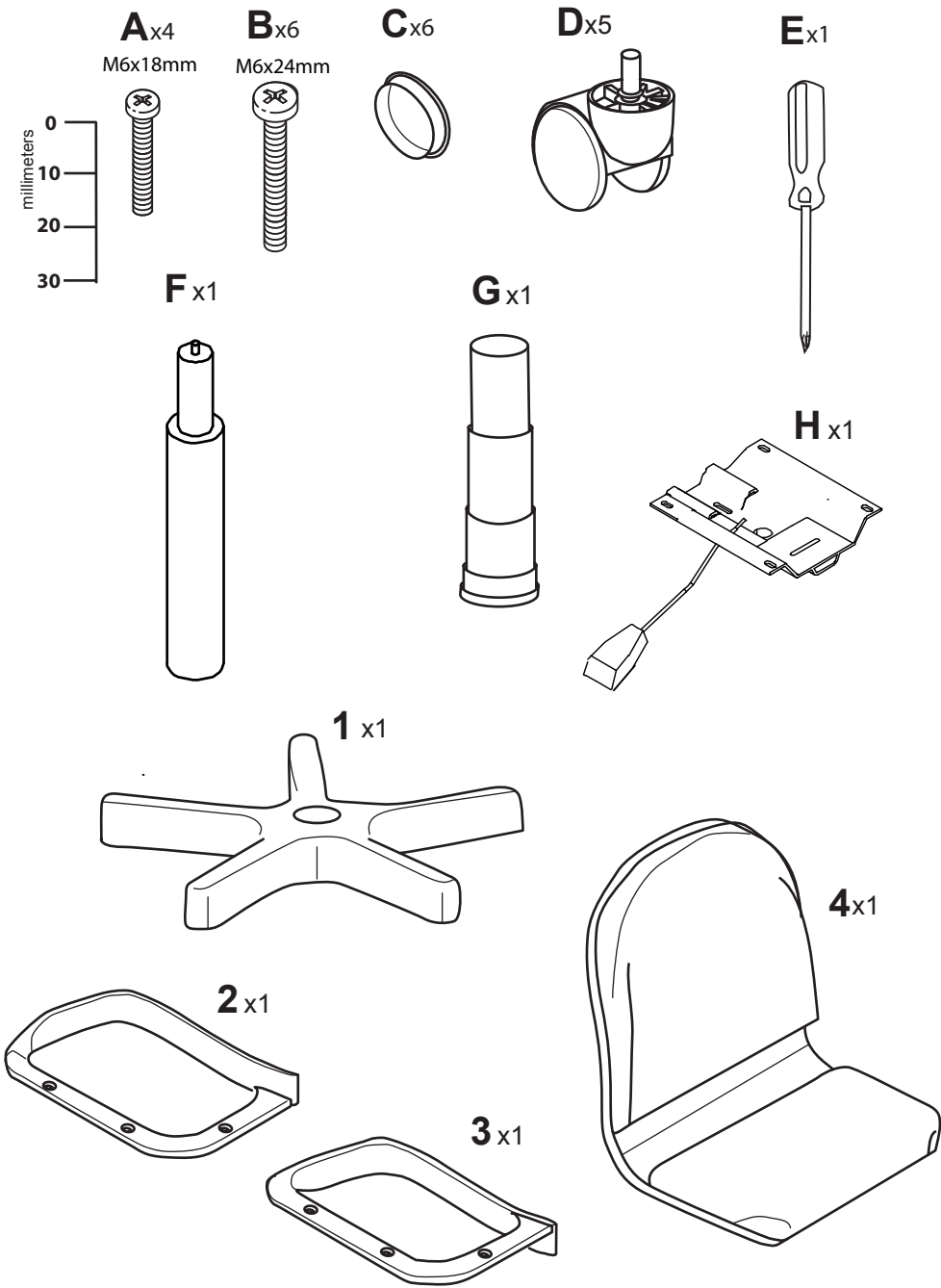

STEP 1

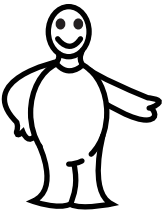

Bx6
M6x24mm

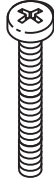

Cx6

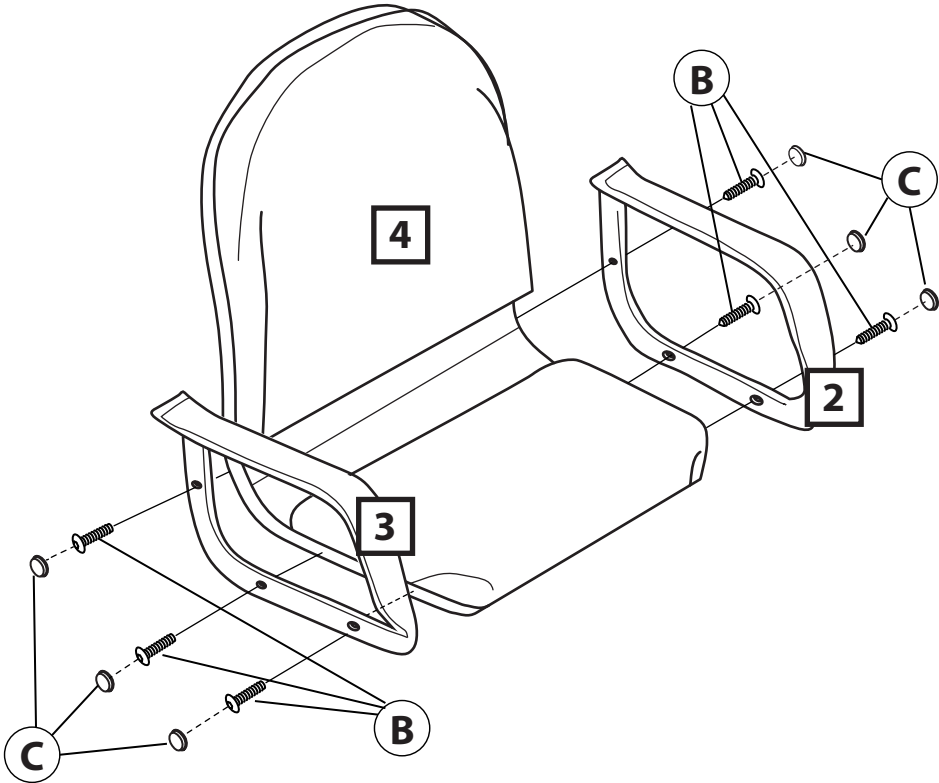

STEP 2

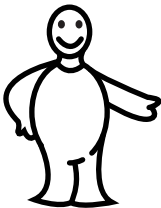

A_{x4}
M6x18mm

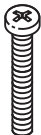

+

H_{x1}

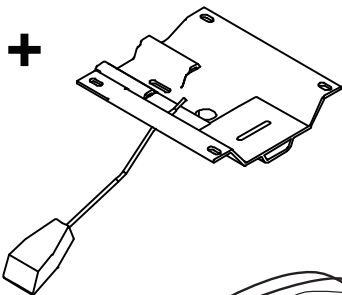

+

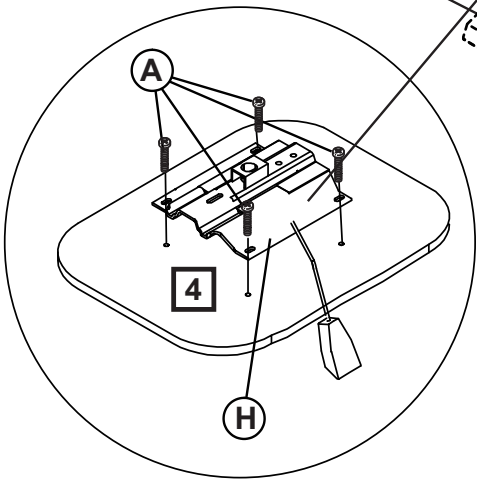
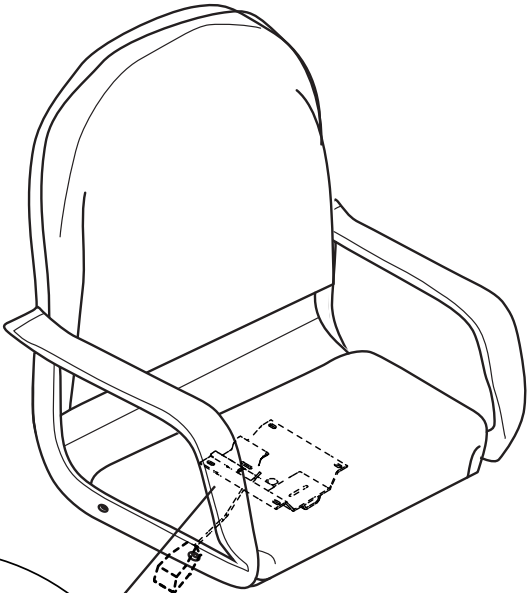

STEP 3

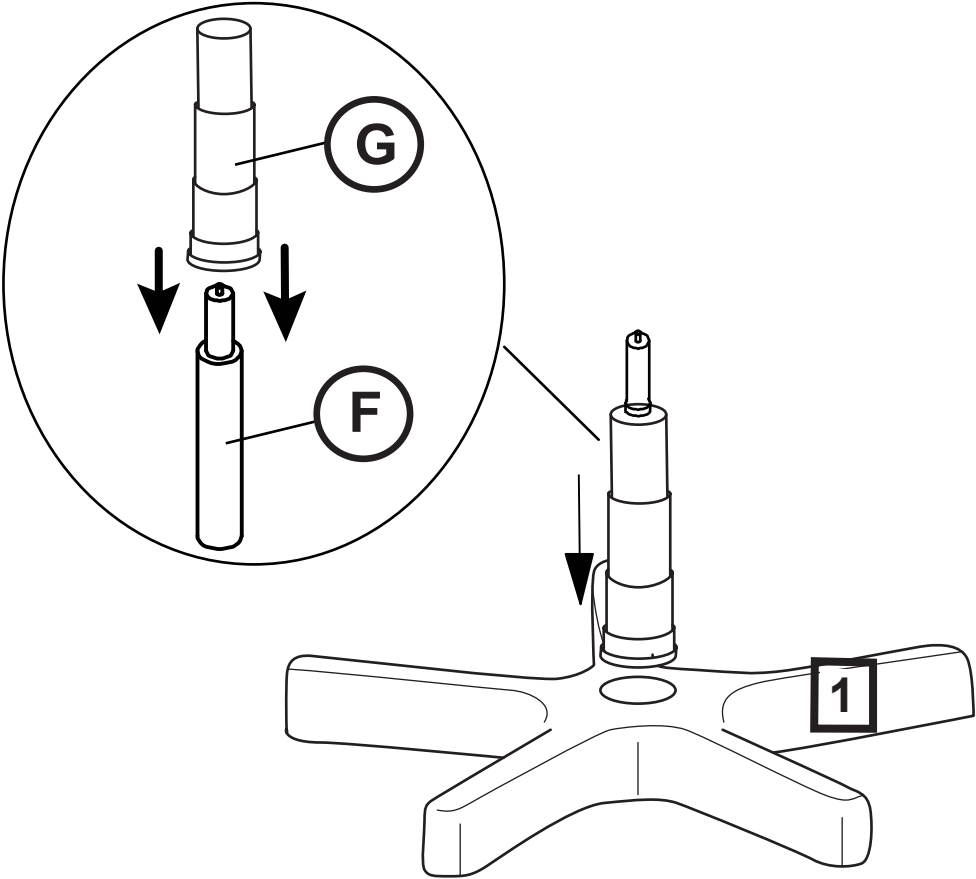
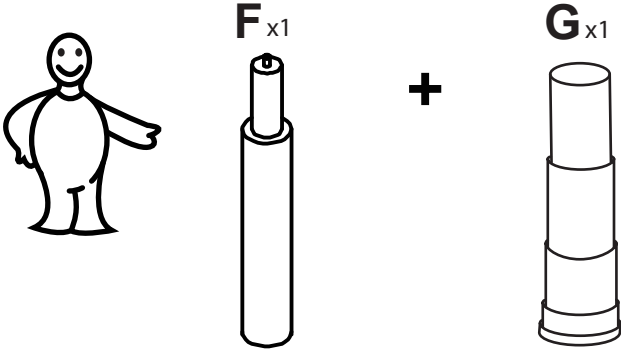

STEP 4

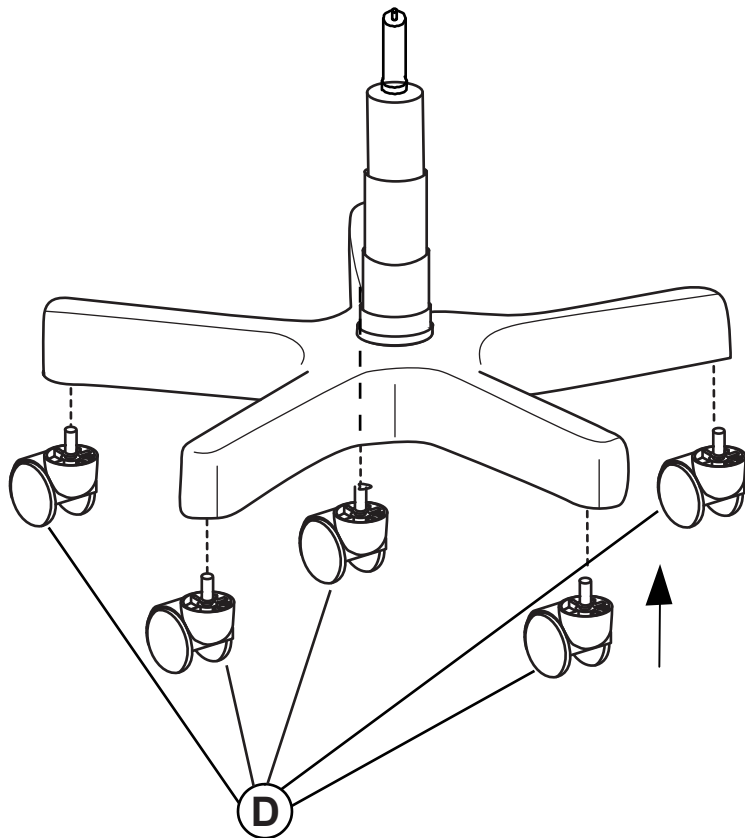
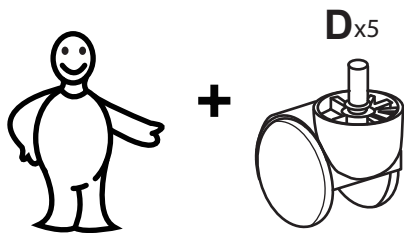

STEP 5

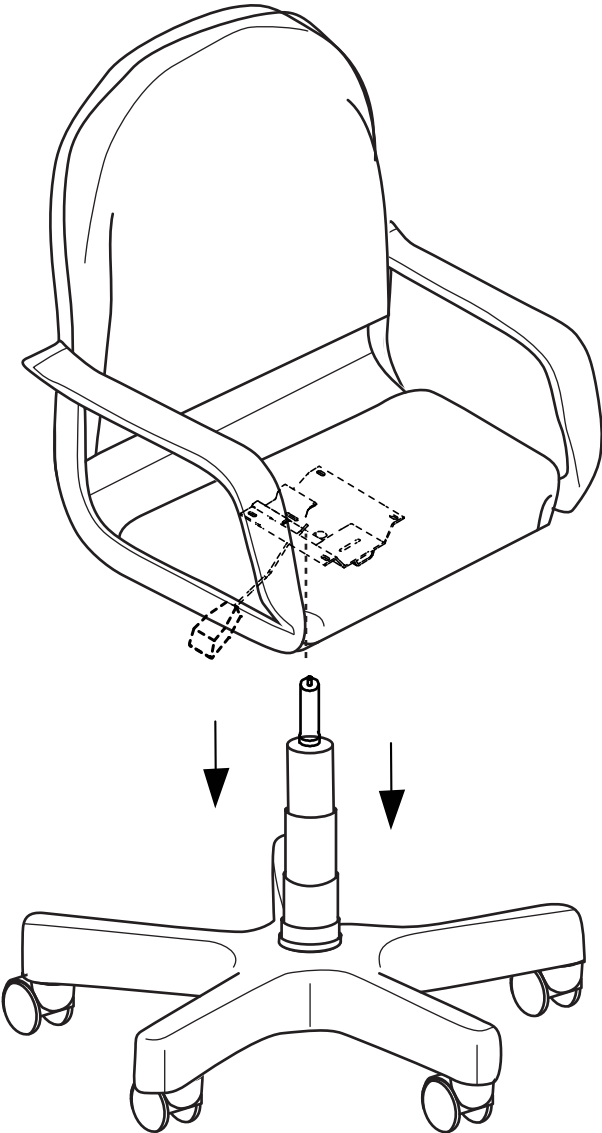
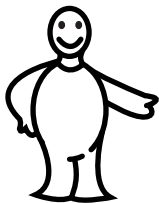

STEP 6

CHAIR ADJUSTMENTS UP / DOWN

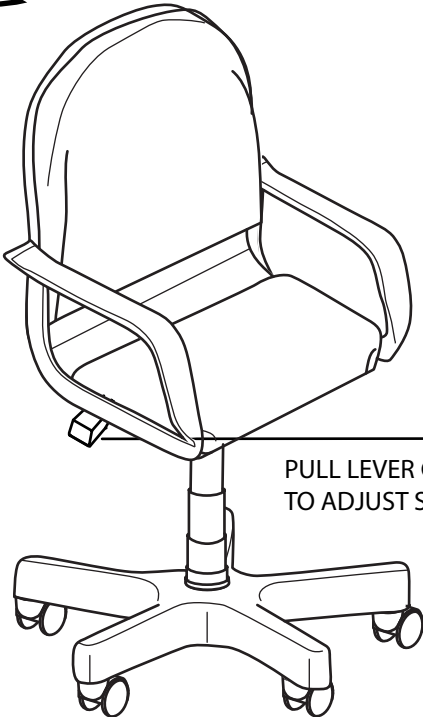
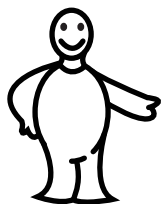

PULL LEVER GENTLY UPWARD
TO ADJUST SEAT HEIGHT

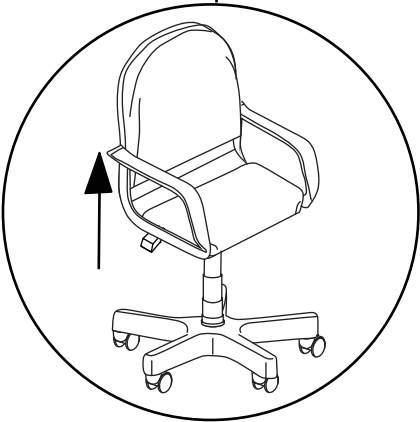
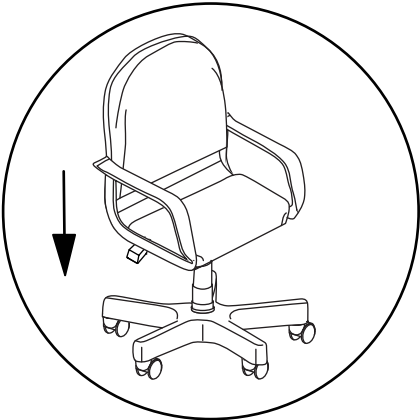

Schoenfeld International Inc and THUNDERDOG
5001 American Boulevard West
Suite 275
Bloomington, Minnesota 55437

©Schoenfeld International Inc., 2013
TCE15: Ver. 1.0 May 2013