

Basic Connection

Coaxial / RF Cable / Antenna

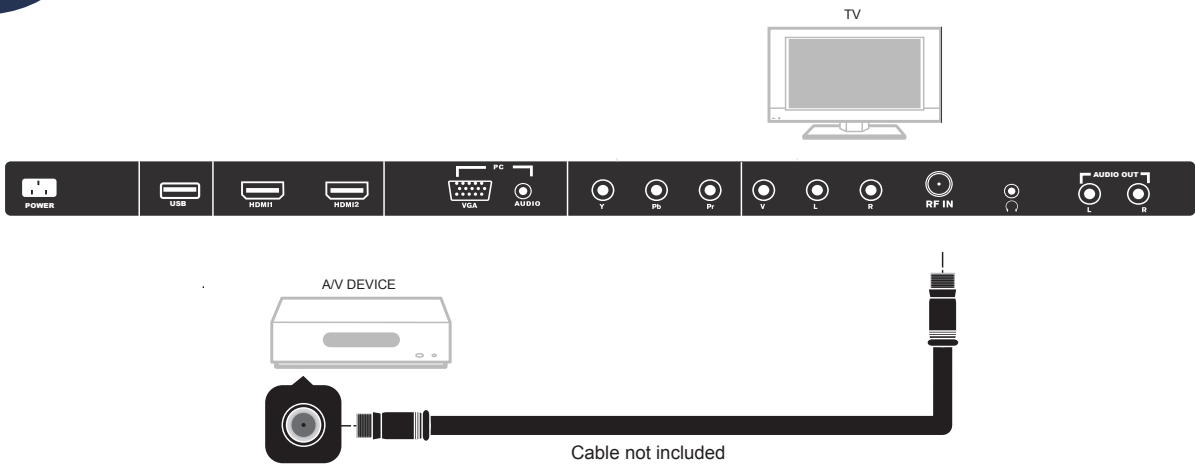

Connect Power Cord

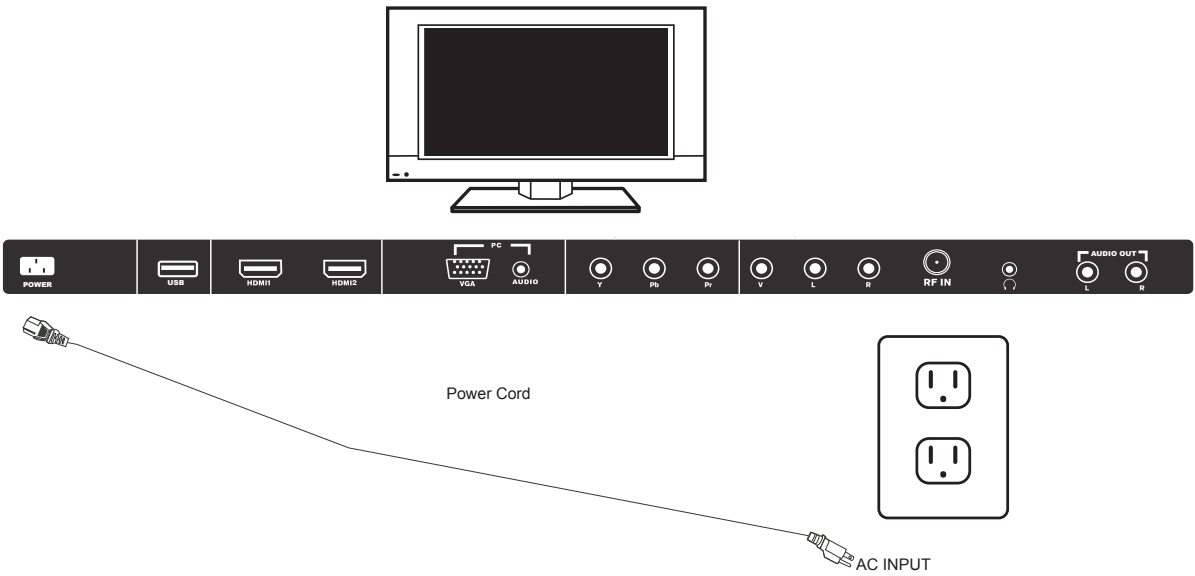

Press the POWER button on the remote control to turn on the TV

Turn to page 17 of the User Manual to select your TV signal source and channels (if needed).

QUICK START GUIDE



Simple Steps for Connecting your TV to A/V Devices



IMPORTANT NOTE:
During setup, do NOT run the “Channel Auto Scan” function if your TV is connected to a Cable or Satellite set top box.

See page 17 of the User Manual for additional details on this setup step.

A/V Devices Include:

- Blu-Ray® Disc Players
- DVD Players
- Cable, Satellite, or Set-Top Boxes
- VCRs
- Game Consoles

If you need additional help, please consult your user manual.

“HDMI”, the HDMI Logo and High-Definition Multimedia Interface are trademarks or registered trademarks of HDMI Licensing LLC.”
“Blu-ray Disc” is a trademark of Blu-ray Disc Association, registered in the U.S. and other countries. All other trademarks are the property of their respective owners.

Insert TV into Stand Receiver and
Install Batteries in Remote Control

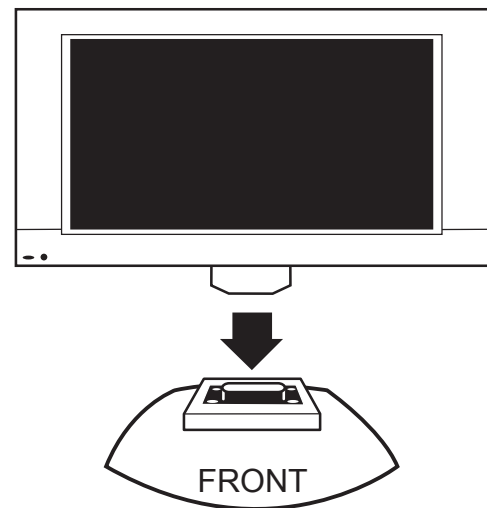

Stand Receiver shape may differ, but stands assemble the same.
Use the enclosed screws to secure the stand.



Better
Connection

Component

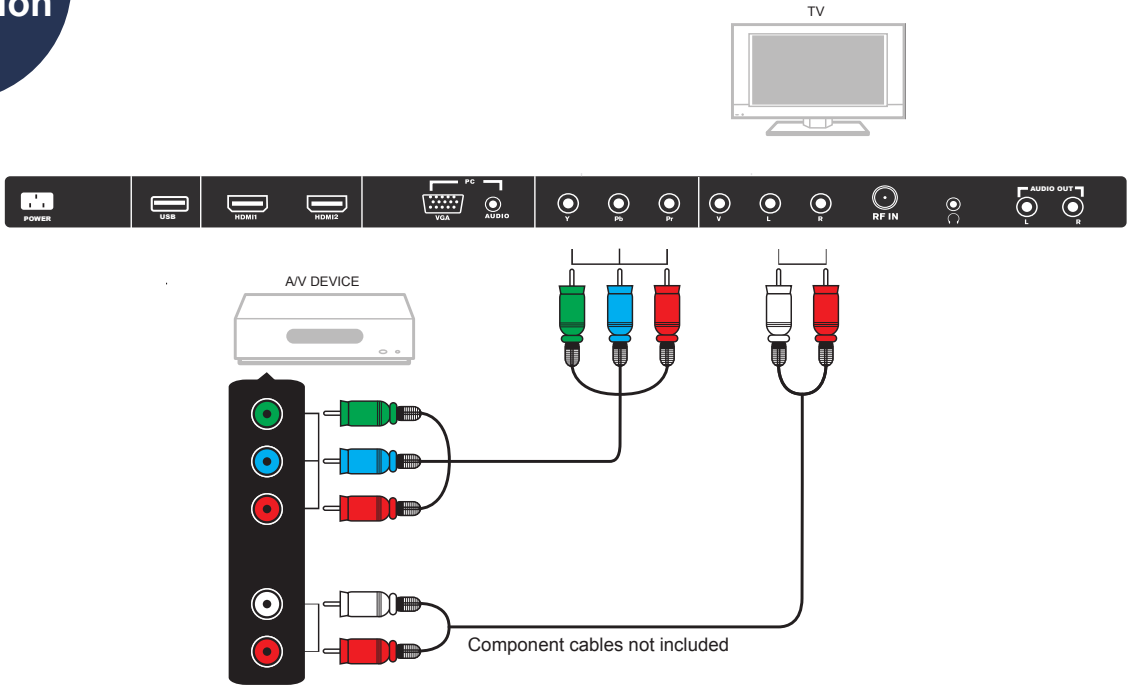

Best
Connection

HDMI

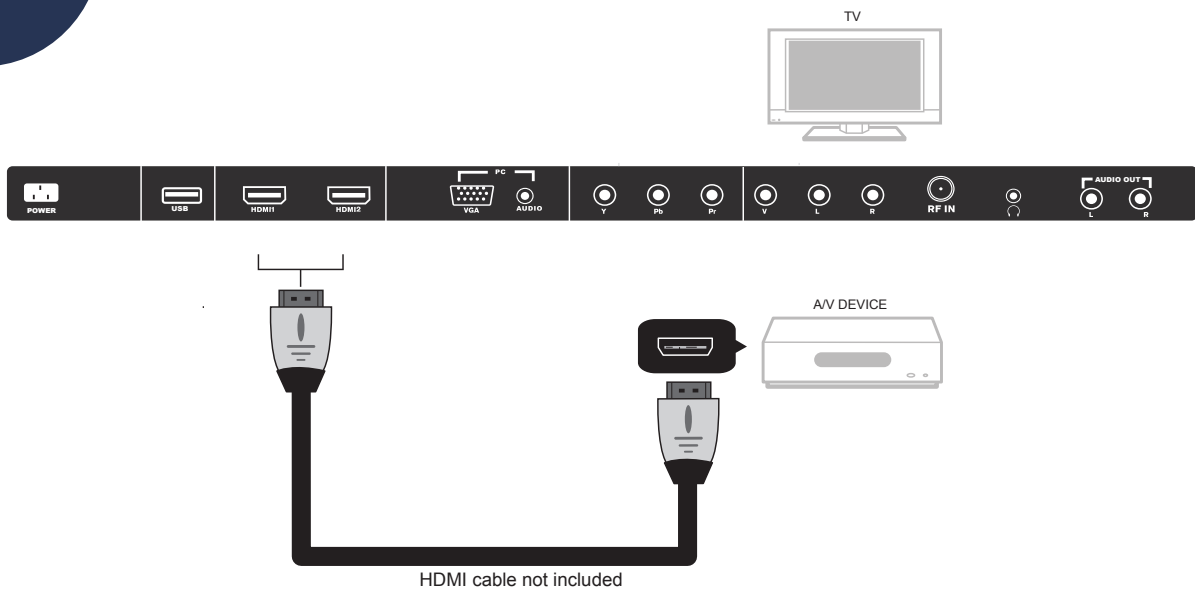

Good
Connection

Composite

